

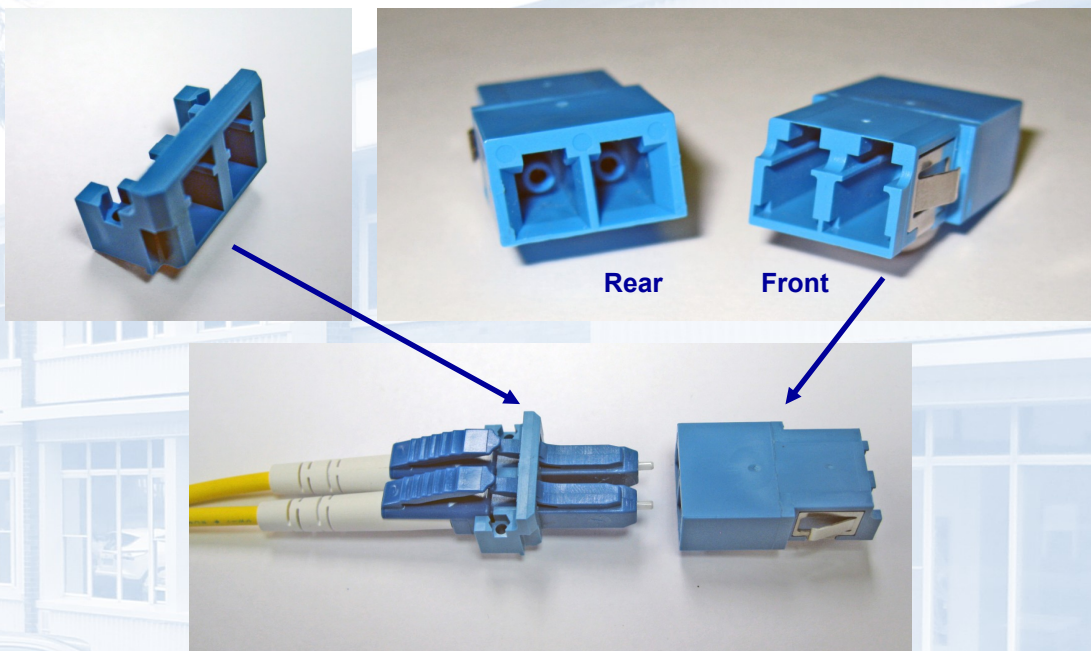

# Blind-Mate Duplex LC Connectors



## Description

OFP's Single Mode Blind Mating Duplex LC connectors provide a space efficient solution that allow fiber plant cabling to remain installed when active electronic PCB signal processing cards need to be removed for service, repair or replacement.

The signal processing card locking mechanism provides the normal force to mate the extended LC connectors installed on the removable card to the rear adaptor and fiber plant side standard LC connectors.

## Key Features

- ROHS & UL94 VO complaint
- Single Mode Duplex LC
- Extended LC type used internally
- Standard LC used for external patching and jumpers to avoid installer confusion.
- Daughter Card Kit includes mounting hardware for 1.5mm PCB thickness.
- Extended LC to Standard LC jumpers available for connecting hardware to the chassis

## Ordering information:

Rear Panel Adaptor:  
P/N: ADA-BM-DLC

Daughter Card Kit:

P/N: ADA-DC-DLC

Daughter Card Latch Block

P/N: ADA10638

## Optical Fiber Packaging Ltd.

Holland Centre  
Holland Road Industrial Estate  
Haverhill  
Suffolk  
England CB9 8PR UK

Phone: +44 (0) 1440-766636  
E-mail: sales@ofpgco.com

[www.ofpgco.com](http://www.ofpgco.com)



# Blind-Mate Duplex LC Connectors

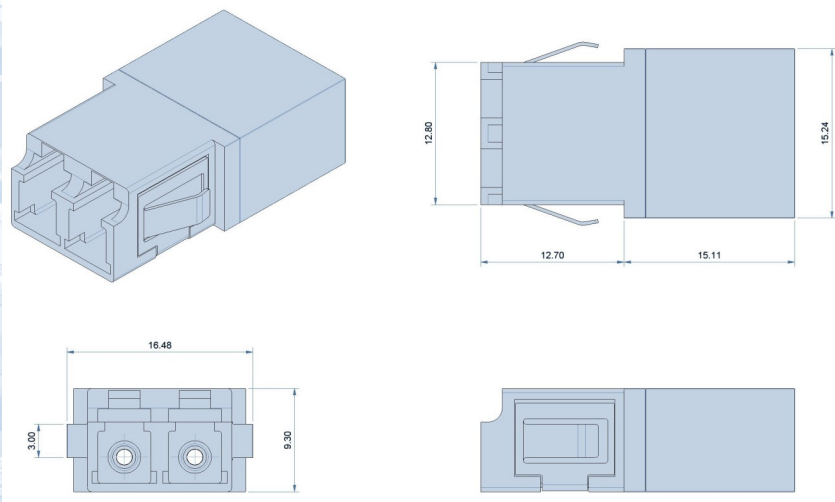
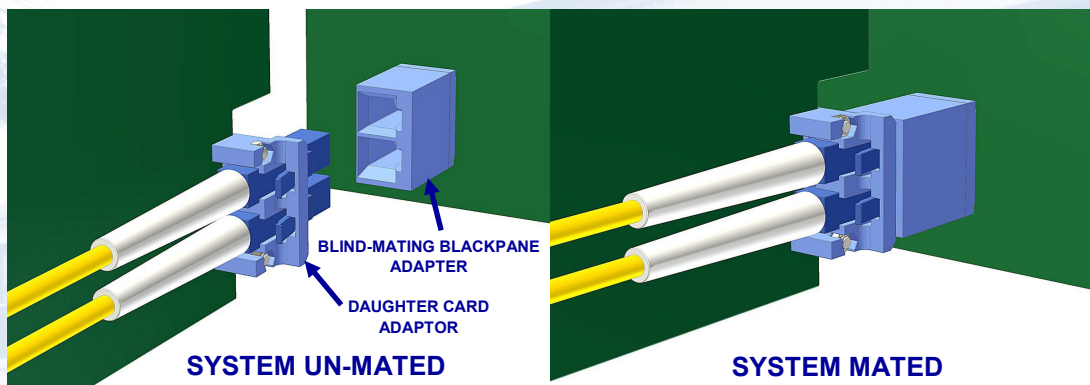

## BLIND-MATING BLACKPANE ADAPTER

Part Number: ADA-BM-DLC

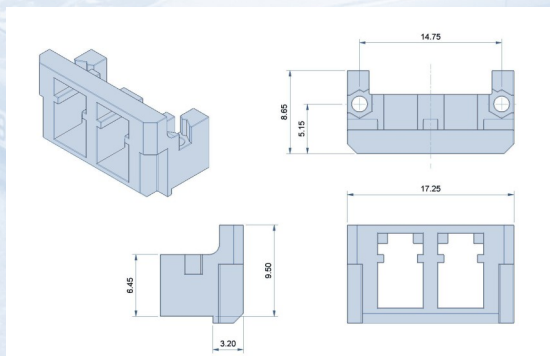

## DAUGHTER CARD ADAPTOR LATCH BLOCK

Part Number: ADA10638

### Optical Fiber Packaging Ltd.

Holland Centre  
Holland Road Industrial Estate  
Haverhill  
Suffolk  
England CB9 8PR UK

Phone: +44 (0) 1440-766636  
E-mail: [sales@ofpgco.com](mailto:sales@ofpgco.com)

[www.ofpgco.com](http://www.ofpgco.com)





# Blind-Mate Duplex LC Connectors

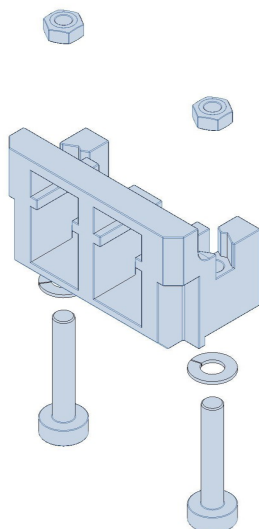

## DAUGHTER CARD ADAPTOR KIT ADA-DC-DLC

### Hardware Included

- Daughter Card Adaptor Latch Block Part Number: ADA10638
- 2 Each: #0-80 Phillips Pan Head SS Screw
- #0-80 SS Hex Nut
- #0 Spring Lock Washer

### Optical Fiber Packaging Ltd.

Holland Centre  
Holland Road Industrial Estate  
Haverhill  
Suffolk  
England CB9 8PR UK

Phone: +44 (0) 1440-766636  
E-mail: [sales@ofpgco.com](mailto:sales@ofpgco.com)

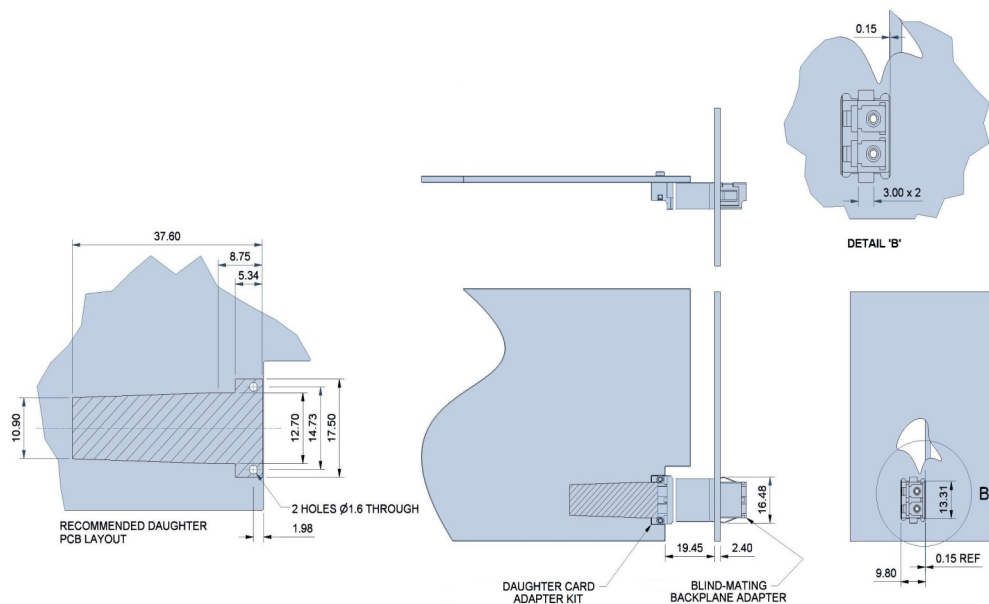

[www.ofpgco.com](http://www.ofpgco.com)